





5 Feet

Equipment List

[6 Total Tables, 48 Total Chairs]

- | | | |
|--|--|--|
|  48 1.33' X 1.33' Banquet |  1 6' X 2' Bar |  1 6' X 2' Buffet |
|  6 60" Round |  1 1.5' Bar Stool | |

Notes

4th Floor South Wing for Test - April 6, 2024 at 12:00 PM

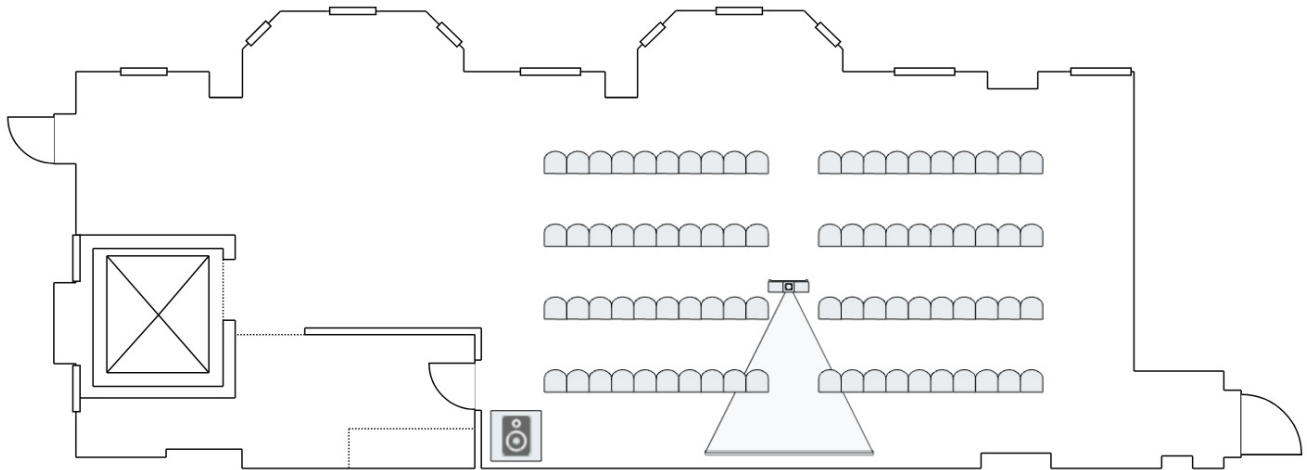

5 Feet

Equipment List

[0 Total Tables, 80 Total Chairs]

 80 1.33' X 1.33' Banquet

 1 10' X 10' Screen + Projector

 1 3' X 3' Speaker

Notes

4th Floor South Wing for Test - April 6, 2024 at 12:00 PM

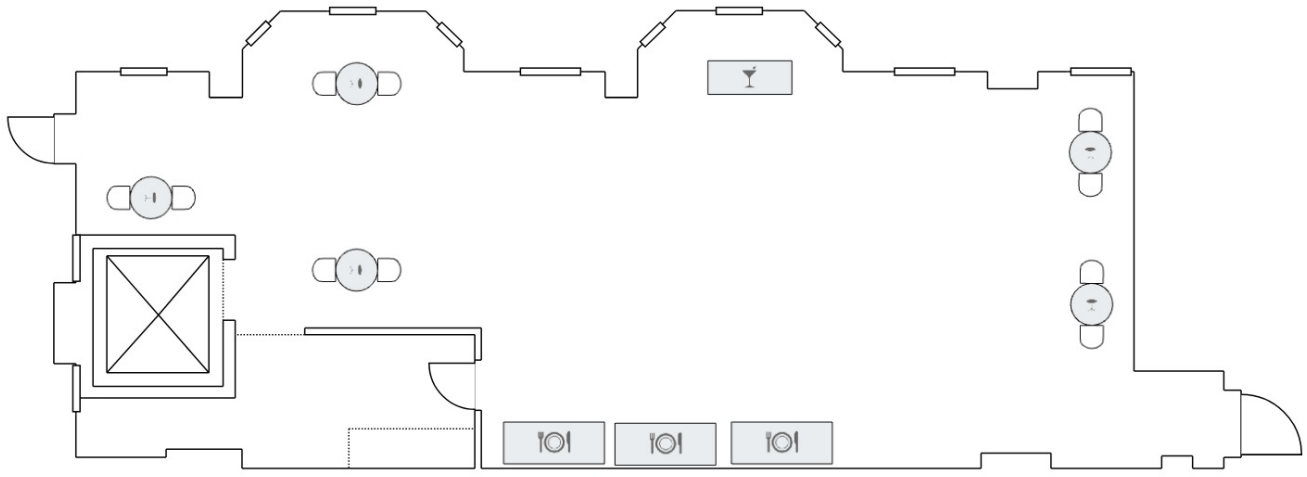

5 Feet

Equipment List

[5 Total Tables, 10 Total Chairs]

- | | | | | | | | | |
|---|----|-----------------------|---|---|------------------|---|---|-------------|
|  | 10 | 1.38' X 1.38' Banquet |  | 3 | 6' X 2.5' Buffet |  | 1 | 5' X 2' Bar |
|  | 5 | 2.5' High Boy | | | | | | |

Notes



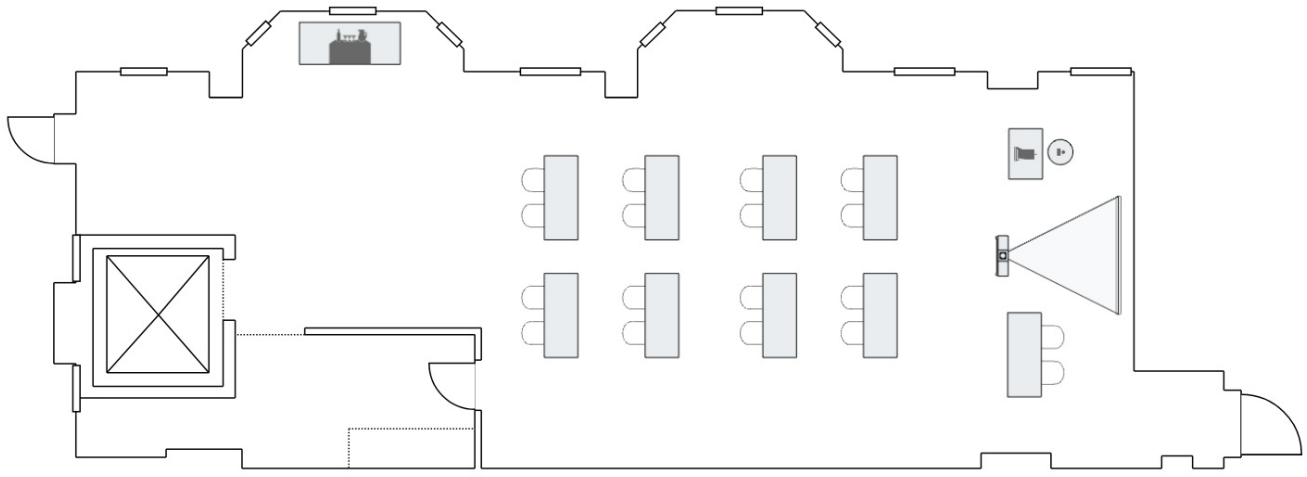

4th Floor South Wing for Test - April 6, 2024 at 12:00 PM



5 Feet

Equipment List

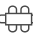
[9 Total Tables, 18 Total Chairs]

- | | | | | | | | | |
|---|----|-----------------------|---|---|----------------------------|---|---|----------------------------|
|  | 18 | 1.33' X 1.33' Banquet |  | 1 | 6' X 2.5' Beverage Station |  | 1 | 7' X 7' Screen + Projector |
|  | 9 | 5' X 24" Rectangle |  | 1 | 2' X 3' Podium | | | |

Notes



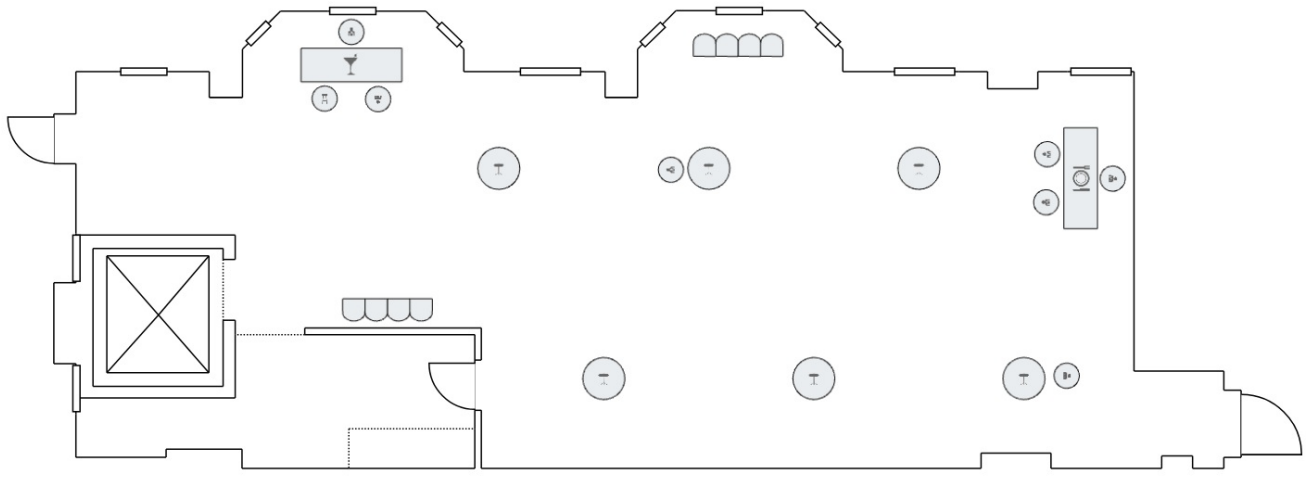

4th Floor South Wing for Test - April 6, 2024 at 12:00 PM



5 Feet

Equipment List

[6 Total Tables, 8 Total Chairs]

- | | | | | | | | | |
|---|---|-----------------------|---|---|----------------|---|---|----------------|
|  | 8 | 1.33' X 1.33' Banquet |  | 1 | 6' X 2' Bar |  | 1 | 6' X 2' Buffet |
|  | 6 | 2.5' High Boy |  | 1 | 1.5' Bar Stool | | | |

Notes

4th Floor South Wing for Test - April 6, 2024 at 12:00 PM